



TERMINATION OF BASIC AUTHENTICATION FOR GOOGLE (GMAIL) FROM **30 MAY 2022**

**REASON: GOOGLE PLAN TO INCREASE THE
SECURITY OF THE ACCOUNTS**

**MAY AFFECT: GOOGLE (GMAIL) ACCOUNTS
USED FOR SCAN TO EMAIL AND EMAIL RX
PRINT**

* End user can make these required changes to Google account settings and Konica Minolta Multifunction Printer settings. If you require assistance from Konica Minolta to perform the settings from this document – this will result in an additional charge. Please contact Konica Minolta Support at <https://www.konicaminolta.com.au/support>.

(1) Planned change details:

Reason: Google decided to increase the security of the personal accounts

Starting **May 30, 2022**, Google(Gmail) will increase the security and will no longer support the use of Multifunction Print devices or third-party email applications which ask to sign into the Google/Gmail Account using **only** username and password (Basic Authentication).

Google official announcement is located at next URL: <https://support.google.com/accounts/answer/6010255?hl=en>

Less secure apps & your Google Account

To help keep your account secure, starting **May 30, 2022**, Google will no longer support the use of third-party apps or devices which ask you to sign in to your Google Account using only your username and password.

Please note this deadline does not apply to Google Workspace or Google Cloud Identity customers. The enforcement date for these customers will be announced on the Workspace blog at a later date.

For more information, please continue reading.

Special Note on Apple Device Sign-Ins. Users who have not recently signed into their Google Account using only username and password will be able to only make new sign in attempts using the Google account type starting from **February 28, 2022**. Existing users may continue to sign into their Google Account using their username and password until **May 30, 2022**.

If an app or site doesn't meet our [security standards](#), Google might block anyone who's trying to sign in to your account from it. Less secure apps can make it easier for hackers to get in to your account, so blocking sign-ins from these apps helps keep your account safe.

Expected symptoms after Google increases the security:

- Increased security is expected to affect e-mail transmission in Konica Minolta Multifunction Print devices that use Gmail SMTP servers to send Scan to Email. It will also affect email reception using POP3 Gmail server in Konica Minolta Multifunction Printers with LK-110 iOption where Email RX Print feature is used.
- Scan to E-mail using Gmail may fail with Error Code: 535, Error Details: Server connection error

Solution for continuing to use Gmail server for Scan to Email (see next pages for detailed information):

- Access the Google account Security settings and activate “2-Step Verification”. **See step (2) in the next page.** Some Google business accounts may not have this option available.
- In Google account Security settings create a new “App Password”. **See step (3) in page 5.** Some Google business accounts may not have this option available.
- Use the newly created “App Password” in Konica Minolta Multifunction Print devices that use Gmail for Scan to E-mail for sending/receiving E-mail. **See step (4) in page 7.**

The end user is responsible for making these required changes to the Google account settings and Konica Minolta Multifunction Printer settings. If you require assistance from Konica Minolta to perform the settings from this document – this will result in an additional charge. Please contact Konica Minolta Support at

<https://www.konicaminolta.com.au/support>.

(2) How to enable 2-Step Verification

1. Log into the Google account.
2. Click **Security**, click **2-Step Verification**. This information is also available via Google Support at the following URL : <https://support.google.com/accounts/answer/185839>

Note: use reliable 2-step verification, for example avoid using temporary mobile numbers.

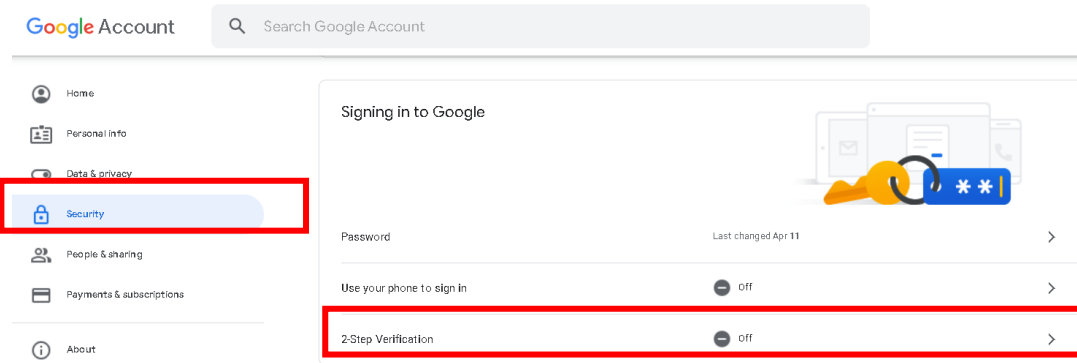

3. Click GET STARTED.

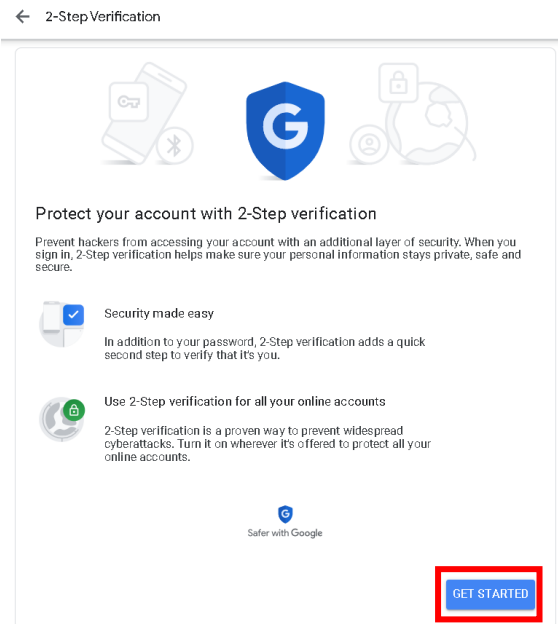

4. Enter password and click Next.

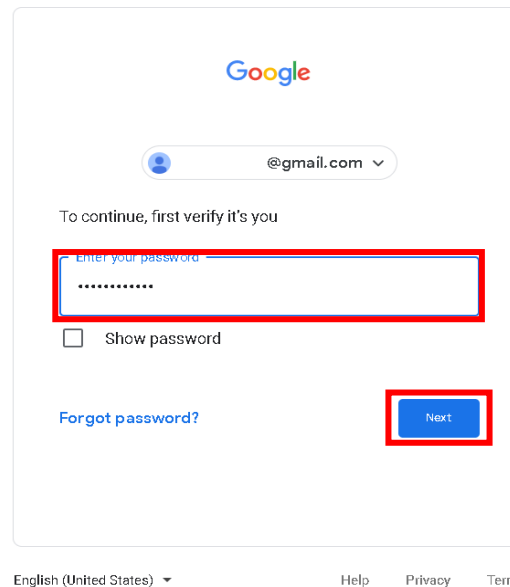

5. Select a preferred option and proceed.

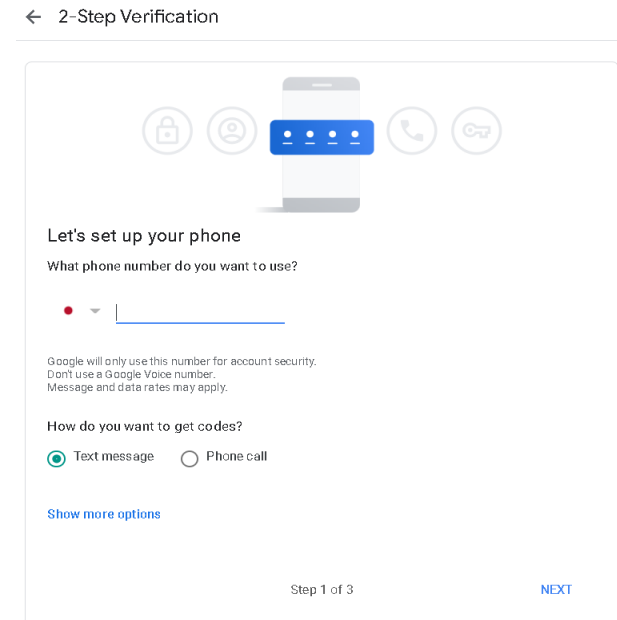

6. Click TURN ON.

← 2-Step Verification



Turn on 2-Step Verification?

Second step: **Google prompt (default)**
Backup option: **Backup codes**

You'll stay signed in to **kmi.opslab@gmail.com** on these devices: **iPhoneSE**.

You might be signed out of your other devices. To sign back in, you'll need your password and second step.

TURN ON

7. Click left arrow.

← 2-Step Verification

2-Step Verification is ON since Apr 11, 2022

TURN OFF

8. Confirm 2-Step Verification is On.

Signing in to Google



Password Last changed Apr 11 >

2-Step Verification On >

App passwords None >

(3) How to create App password

Note: "App passwords" menu is available only when 2-Step Verification is enabled.

1. Click **Security** then click **App passwords**.

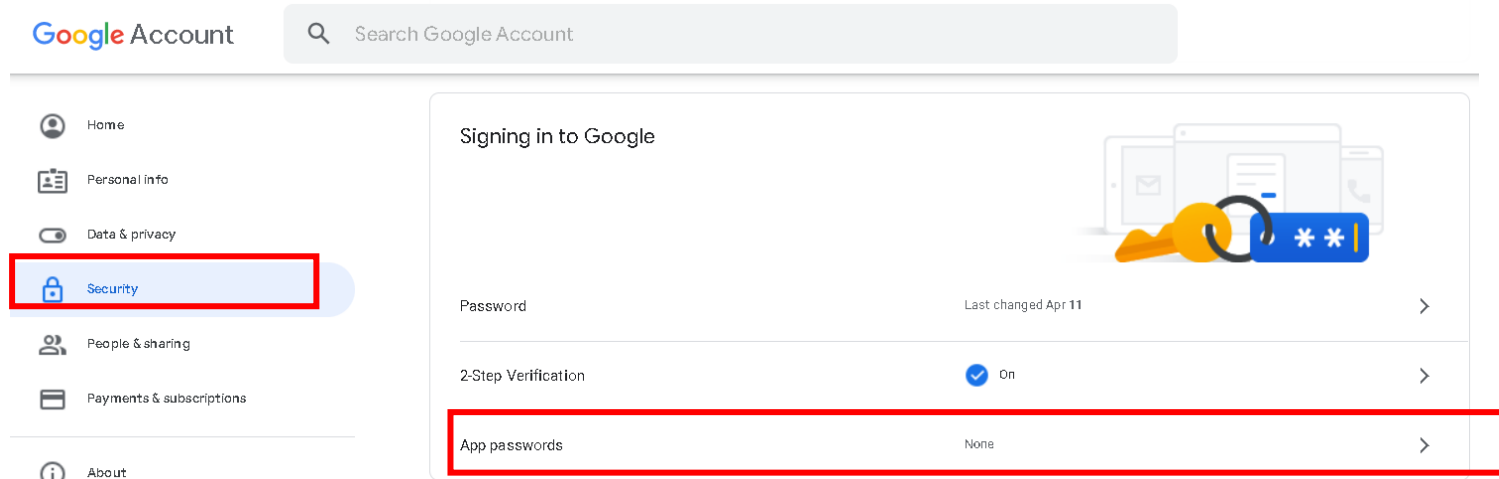

2. Enter password and click Next.

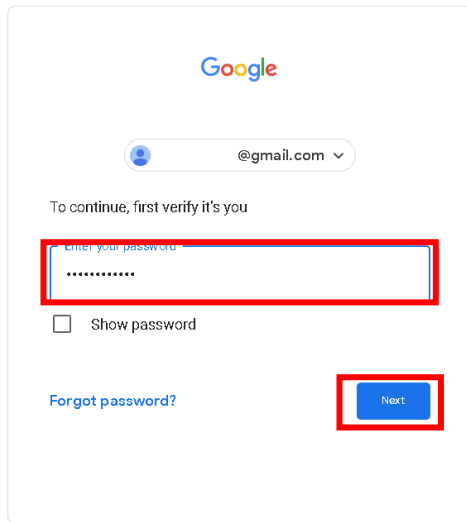

3. Select **Mail** from the left drop-down list and select **“Other (Custom name)”** from the right drop-down list.

← App passwords

App passwords let you sign in to your Google Account from apps on devices that don't support 2-Step Verification. You'll only need to enter it once so you don't need to remember it. [Learn more](#)

You don't have any app passwords.

Select the app and device you want to generate the app password for.

Mail Select device

- iPhone
- iPad
- BlackBerry
- Mac
- Windows Phone
- Windows Computer
- Other (Custom name)**

GENERATE

5. A new **App password** to be used with the Konica Minolta Multifunction Printer is generated. Take note of the 16-character App password (as this will be required later) then click **DONE**.

Generated app password

Your app password for your device

abcd efgh ijkl mnop

How to use it

Go to the settings for your Google Account in the application or device you are trying to set up. Replace your password with the 16-character password shown above. Just like your normal password, this app password grants complete access to your Google Account. You won't need to remember it, so don't write it down or share it with anyone.

DONE

Email:

Password:

4. Enter a name describing the Konica Minolta Multifunction Printer model and click **GENERATE**.

← App passwords

App passwords let you sign in to your Google Account from apps on devices that don't support 2-Step Verification. You'll only need to enter it once so you don't need to remember it. [Learn more](#)

You don't have any app passwords.

Select the app and device you want to generate the app password for.

GENERATE

6. Confirm the name is added to the list of **“Your app passwords”**. You can logout from Google/Gmail.

← App passwords

App passwords let you sign in to your Google Account from apps on devices that don't support 2-Step Verification. You'll only need to enter it once so you don't need to remember it. [Learn more](#)

Your app passwords

Name	Created	Last used	
C250i	6:11 PM	–	

(4) How to update Email TX password in the Konica Minolta Multifunction Printer

1. In Multifunction Printers where Scan to Email via Gmail **functioned until 30 May 2022** -> only the Email TX password should be changed on the Konica Minolta Multifunction Printer.

Access the Konica Minolta Multifunction Printer via Web Connection or via the operating panel menu > Login as Administrator > Network > E-mail Setting > E-mail TX (SMTP) > Password

To access Web-connection the following is required: a PC with network connection to the Konica Minolta Multifunction Printer, the IP address of the Konica Minolta Multifunction Printer and the Konica Minolta Multifunction Printer administrator password.

2. Enter the 16-character App password created in the previous step ('How To Create App Password') and click /tap OK.

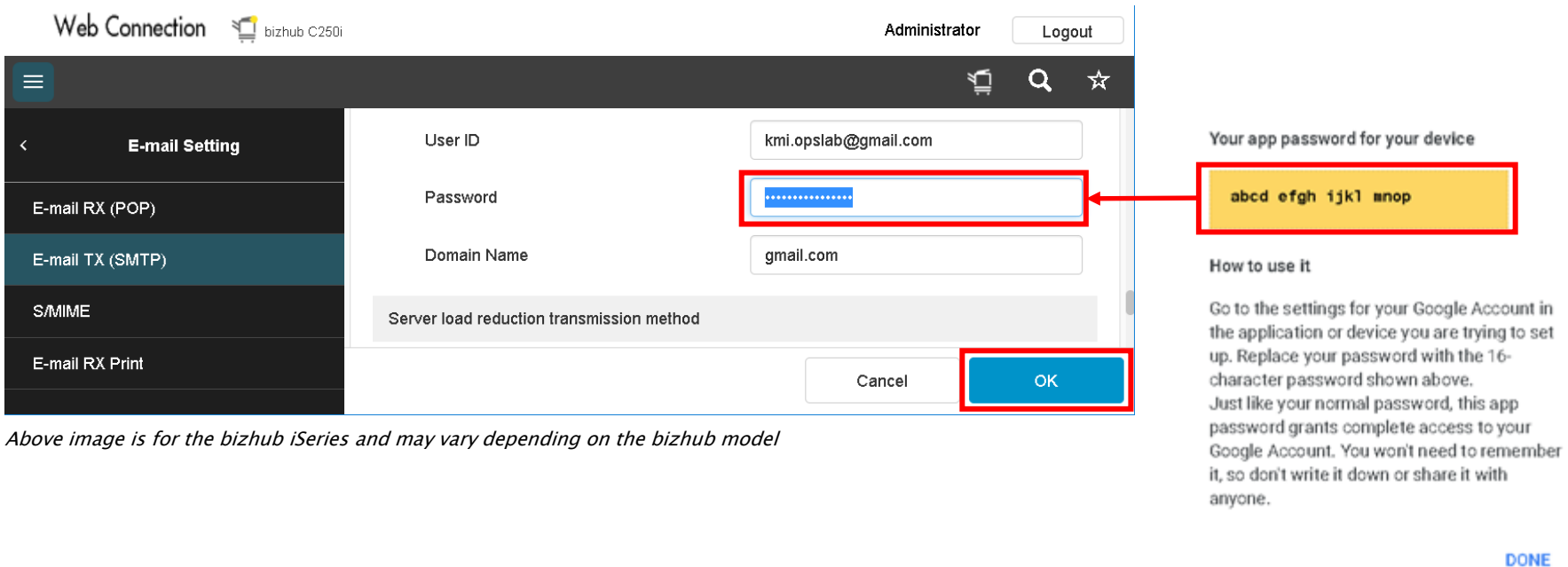

The screenshot shows the 'Web Connection' interface for a bizhub C250i printer. The user is logged in as 'Administrator'. The 'E-mail Setting' menu is open, and the 'E-mail TX (SMTP)' option is selected. The 'Password' field is highlighted with a red box, and a red arrow points to a yellow box containing the 16-character app password 'abcd efgh ijkl mnop'. The 'OK' button is also highlighted with a red box. A 'DONE' button is visible at the bottom right.

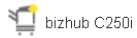
Web Connection  Administrator

E-mail Setting

E-mail RX (POP)

E-mail TX (SMTP)

S/MIME

E-mail RX Print

User ID: kmi.opslab@gmail.com

Password:

Domain Name: gmail.com

Server load reduction transmission method

Your app password for your device

abcd efgh ijkl mnop

How to use it

Go to the settings for your Google Account in the application or device you are trying to set up. Replace your password with the 16-character password shown above. Just like your normal password, this app password grants complete access to your Google Account. You won't need to remember it, so don't write it down or share it with anyone.

DONE

Above image is for the bizhub iSeries and may vary depending on the bizhub model

3. Send a test job and confirm that Scan to E-mail transmission works with the newly applied settings.

END of document