



KONICA MINOLTA

Giving Shape to Ideas

YOUR MOST PRODUCTIVE OFFICE COMPANION



bizhub 368e/308e

Boost everyday business productivity

Achieve higher productivity with Konica Minolta bizhub 368e/308e. Swiftly output monochrome documents at high resolution. Intuitively take advantage of feature-rich capabilities. Securely handle confidential business data. And flexibly complete high-volume jobs with advanced paper finishing options. Professional quality production of business documents has never been easier.

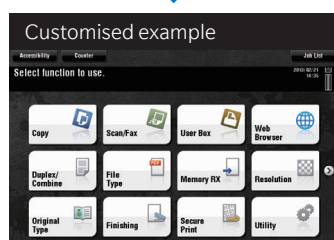
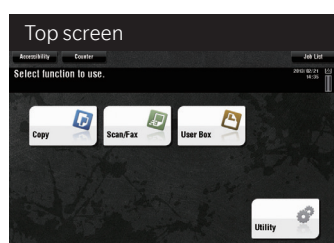

User-friendly multi-touch screen

The 9-inch multi-touch screen presents information with clarity in an intuitive user interface that everyone can understand.



Connection with mobile devices

Industry standard mobile technologies allow mobile devices to link with bizhub 368e/308e and wirelessly command printing as well as other features.

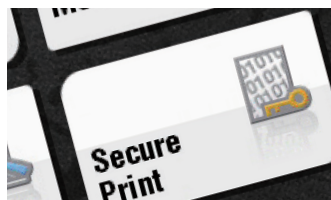

Simple, solid security

Flexible authentication support, easy initial security setup and other security conveniences simplify protection of company assets.



Warm-up Time
20
sec. or less*

Duplex Scanning
160
ipm*

First Copy Time
4.5
sec.*

BW Output
36
ppm*

*20 seconds or less on bizhub 368e I 308e (18 seconds or less on biz hub 308e from sub-power mode). *Single-pass duplex scanning When equipped with DF-704 *bizhub 308e (4.8 seconds or less on bizhub 368e) *bizhub 368e (30 ppm on bizhub 308e)

A more efficient, streamlined workflow

Operational ease and efficiency

User-friendly multi-touch screen

Operation is simplified by a user-friendly 9-inch multi-touch screen with intuitive user interface. The same touch gestures used on mobile devices can be used on the touch screen to simplify operation. Tap to select, double tap to activate, flick to scroll or pinch to magnify. Up to 23 shortcut keys can be set in the main menu for quick and easy access to frequently used functions.

Paper capacity

The standard 1,150-sheet paper capacity can be increased to 3,650 sheets by adding the optional Paper Feed Cabinet. It can be further increased to 6,650 sheets by also adding the optional Large Capacity Unit. Higher capacities let users handle higher-volume workloads with less downtime for paper replenishment.

*The paper supply capacity for all models is based on 80 g/m².

INFO-Palette design

Whether users operate bizhub 368e/308e from its intuitive touch screen or from a connected PC or mobile device installed with our software, the same intuitive user interface is shared to make operation a breeze.

PC-115 (optional)
Max. A3 / 500 sheets
Total 1,650 sheets

PC-215 (optional)
Max. A3 / 500 sheets × 2
Total 2,150 sheets

PC-415 (optional)
Max. A4 / 2,500 sheets
Total 3,650 sheets

Select
One



Standard
1,150
sheets

Max.
6,650
sheets

Multiple
Bypass Tray
(standard)
Max. SRA3
150 sheets

Universal tray
(standard)
Max. A3
500 sheets

Universal tray
(standard)
Max. SRA3
500 sheets

LU-302 (optional)
Max. A4
3,000 sheets

Operational ease and efficiency

Hardcopy digitisation

Scanned hardcopies can be saved as searchable PDFs^{*1} or editable files in the PowerPoint, Excel or Word format.^{*2} The files are small with excellent image quality and can be saved in the internal HDD or mobile devices.

* 1 Optional i-Option LK-102 v3 or LK-110v2 is required.

* 2 Editable Excel/Word formats require optional i-Option LK-110v2. Note: Optional upgrade Kit UK-211 is required.

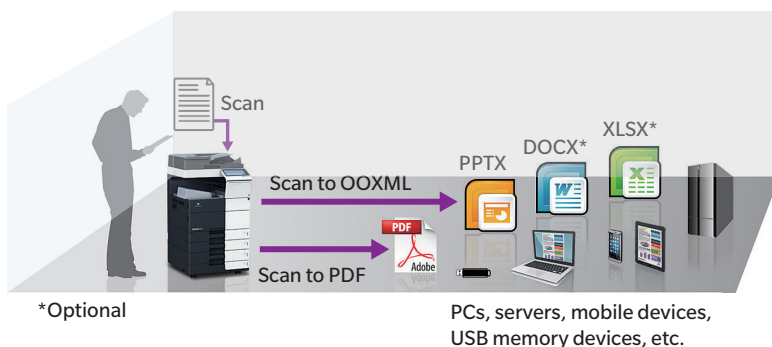

High-speed colour scanning









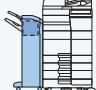
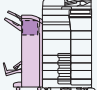

Colour hardcopies are scanned with precision and speed on optional Dual Scan Document Feeder DF-704. Just place hardcopies in the feeder and press the Scan button to scan one-sided pages at 80 ipm (simplex) and two-sided pages at 160 ipm (duplex).*

*When feeding A4 paper sideways (at 300 dpi resolution)

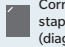
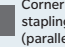
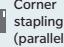
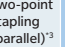
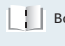

Optional finishers

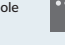
Three optional finishers are available for post-processing tasks. Optional finishers FS-536 and FS-536SD include stapling functions (up to 50 sheets), a 3,000-sheet capacity unit (2,000 sheets on FS-536SD), booklet functions, folding functions and more. Optional inner finisher FS-533 handles stapling from within compact bizhub dimensions.

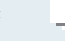
					
Features	Finishing image	FS-536 ^{*1,2}	FS-536SD ^{*1,2}	FS-533	JS-506
Sorting (offset sorting)	 Paper output position is shifted for each set	○	○	○	○
Stapling	 Corner stapling (diagonal)  Corner stapling (parallel) ^{*3}  Corner stapling (parallel) ^{*3}  Two-point stapling (parallel) ^{*3}	Thin/normal (52 – 90g/m ²): 50 sheets Thick (91 – 120g/m ²): 30 sheets Extra thick (121 – 209g/m ²): 15 sheets	Thin/normal (52 – 90g/m ²): 50 sheets Thick (91 – 120g/m ²): 30 sheets Extra thick (121 – 209g/m ²): 15 sheets	Max. 50 sheets ^{*4} (52 – 90g/m ²)	—
Saddle stitching (booklet) & folding	 Booklet  Centre-fold  Letter-fold	—	Max. 20 sheets	—	—
Punching	 Two-hole punch  Upper two-hole punch	Punch kit PK-520 (up to 300g/m ²)	Punch kit PK-520 (up to 300g/m ²)	Punch kit PK-519 (up to 157g/m ²)	—
Cover sheet & insert sheet	 Cover sheet  Insert sheet	○	○	○	○

*1 Paper output to the main body is possible. Up to three output destinations can be set. *2 Relay unit RU-513 is required. *3 Parallel stapling is only compatible with A3, A4/B5 vertical and A4/A5 horizontal on FS-536/FS-536SD.

*4 Diagonal corner stapling is not possible.

Easy connectivity

Connect with mobile devices

Enjoy a flexible mobile work style by using bizhub 368e/308e together with iOS, Android and Windows 10 mobile devices. Users can take advantage of printing and other bizhub features through their favourite industry standard mobile technologies (see below).

Convenient Mobile Touch Area

Pair Android mobile devices^{*1} with bizhub 368e/308e by simply holding them close to the Mobile Touch Area on the multi-touch screen. NFC (Near Field Communication) ensures smooth, quick connections. The Mobile Touch Area can also be used to log in, print files, scan documents and import scanned data.^{*2} iOS devices pair using Bluetooth LE (BLE).^{*3}

^{*1} Android OS 4.4 or higher and Konica Minolta Mobile Print must be installed.

^{*2} Initial setup required for logging in. Wireless LAN environment required for printing and scanning.

^{*3} Optional Device Connection I/F Kit EK-609 is required.

bizhub Remote Access

The bizhub Remote Access app allows operation of bizhub 368e/308e from Android devices and iPhone/iPad/iPod touch. Users can wirelessly operate bizhub hardware and software keys, enter data, import scanned data, send data from bizhub 368e/308e using the mobile device's address book and more.

Wireless LAN*

Access Point mode and Simple Access Point mode via Wireless LAN allow computers and mobile devices in your office to wirelessly connect with bizhub 368e/308e. This creates a fully independent network that supports BYOD (bring your own device) without additional investment. Connection with your company's existing wireless LAN is also supported.

* Optional Upgrade Kit UK-212 or UK-215 is required.

QR code display screen

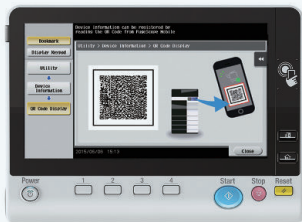

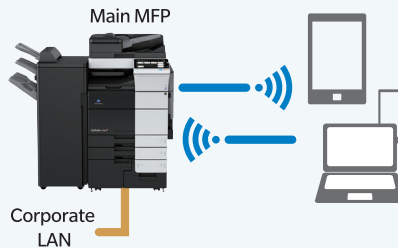

AP mode and Simple AP mode (Wireless LAN)



Up to 5 devices can access bizhub 368e/308e simultaneously in AP mode with UK-212 equipped. Up to 4 devices can access bizhub 368e/308e simultaneously in Simple AP mode with UK-215.

Connect instantly without print drivers to industry standard mobile technologies

		Windows 10 Mobile	Android	iOS
	AirPrint Print from any compatible printer on your company's wireless LAN using AirPrint, Apple's standard printing system. It is compatible with iOS 4.2 and Mac OS 10.7 or later.	✓		
	Mopria Print Service This wireless printing technology provides a universal print driver for printing from devices installed with Android 4.4 or later.		✓	
 <small>Google Cloud Print 2.0 Ready</small> <small>*Available soon</small>	Google Cloud Print Leading technology connects bizhub C759/C659 with the web so users can print from anywhere outside the office regardless of OS, device or application. Note: Google Cloud Print Setup and Google account registration are required.	✓	✓	
	Konica Minolta Print Service This application enables printing directly from devices running Android 4.4 or later through your company's wireless LAN.		✓	
	Konica Minolta Mobile Print Connect mobile devices with bizhub C759/C659 via Wi-Fi to print documents and images as well as import scanned data.	✓	✓	✓

Peace of mind meets feature-rich flexibility

Solid security

Easy authentication

Smooth and efficient password, IC card and biometric (finger vein) authentication are supported. In addition to regular authentication via server, server-free authentication can also be performed directly on the main unit with detailed control of access to each function, including copying, printing, scanning and faxing. These features complement your company's existing security measures to protect important data and hardcopy resources, prevent unauthorised bizhub access and strengthen risk management.

IC card authentication

Authentication is possible with various types of IC card. First command bizhub 368e/308e to print from a PC or mobile device. Then wave the IC card over a card reader on bizhub 368e/308e to print. Authentication can also be performed with any Android device* equipped with an NFC antenna.

*Requires Android 4.4 or later that supports HCE (Host Card Emulation) or PageScope Mobile for Android v4.1 or later.
Notes: Optional Authentication Unit AU-2015 is required.
Compliant non-contact IC cards include FeliCa (IDm), SSFC, FCF, FCF(campus), Felica Private and MIFARE(UID).



TPM (Trusted Platform Module)

Confidential information such as certificates and passwords can be securely managed in bizhub 368e/308e. Just activate the TPM function to encrypt the information and save it in a dedicated storage area in the TPM security chip. This prevents unauthorised reading from external devices.

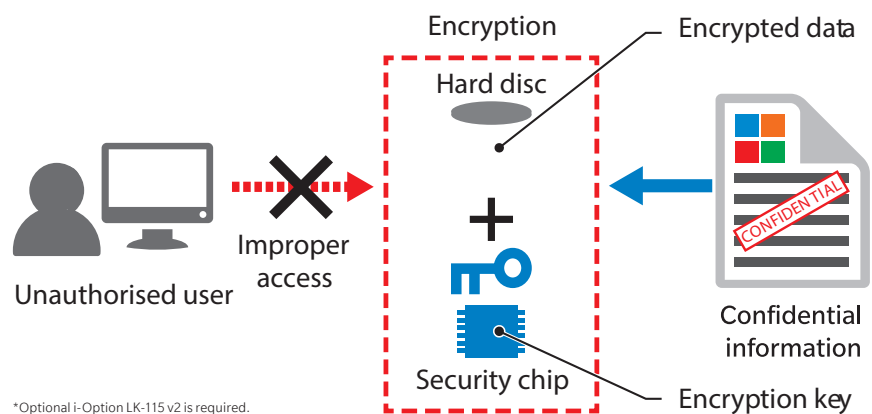

HDD mirroring*

This feature ensures that all data saved on the main HDD is always saved on a backup HDD as well. If the main HDD fails, bizhub 368e/308e automatically switches to the backup HDD to prevent operational downtime and data loss.

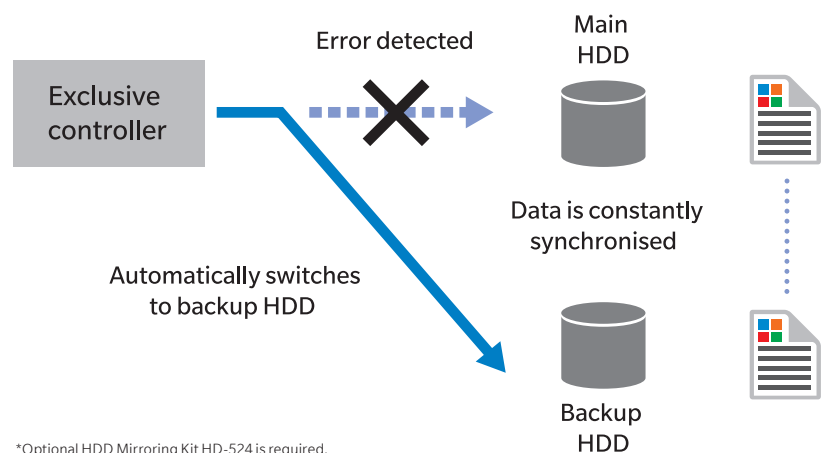



PDF password protection

When saving scanned data as a PDF file, the data can be encrypted to prevent opening of the file unless the user inputs the correct password. The user can also encrypt the PDF with his or her digital certificate, create a PDF/A-based PDF file* and add file properties.

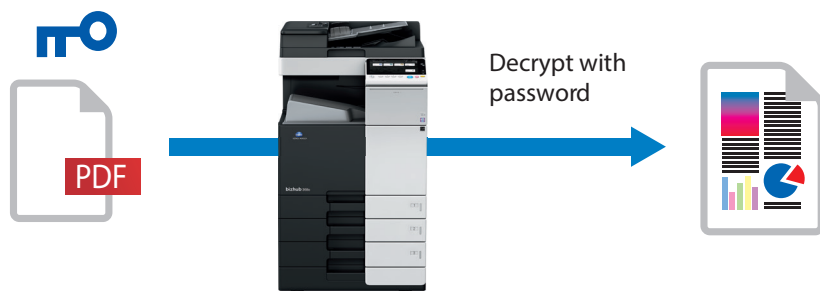

Compliance with industry standards*

This model meets IEEE 2600.1 international protection profile standards, ensuring a high level of document security. All security features have been independently evaluated and certified ISO 15408 EAL3 compliant.

*Application is still pending as of August 2017.

*Optional upgrade Kit UK-211 is required. i-Option LK-102 v3 or LK-110 v2 is also required.

Peace of mind meets feature-rich flexibility

Versatile features

Emperon printing system

Emperon print controller provides network printing functions through standardised printer drivers for PCL and Adobe® Postscript® 3 emulation. Diverse settings allow fine image adjustment such as for glossy mode and edge enhancement. Emperon controller is fully compatible with Windows, Mac, Linux, Unix, Citrix, SAP and other operating systems and printing environments.

N-in-One copying

It's easy to copy multiple pages on a single sheet of paper to reduce paper costs and facilitate viewing of related pages. Users can copy up to 8 pages on a single side of paper when scanning a paper document and up to 16 pages when printing from a file.

Banner print*

Create appealing promotional materials in-house on bizhub 368e/308e. Simply select the Banner Print feature and select the file to print. Then place the long paper (up to 1,200mm) in the bypass tray with the paper setting guide flipped up. When ready, print away for big, beautiful results.

*Requires Optional Banner Paper Setting Guide MK-730.



USB port

The USB port allows transferring of files to and from bizhub 368e/308e via flash drive. Once a file is stored in bizhub 368e/308e, it can be used to output documents or transferred to other devices.

Notes: Compatible with PDF, Compact PDF, JPEG, TIFF, XPS, Compact XPS, OOOXML (docx, xlsx, pptx) files. Some USB flash drives may not be compatible. Print output may differ from what appears on the PC screen.

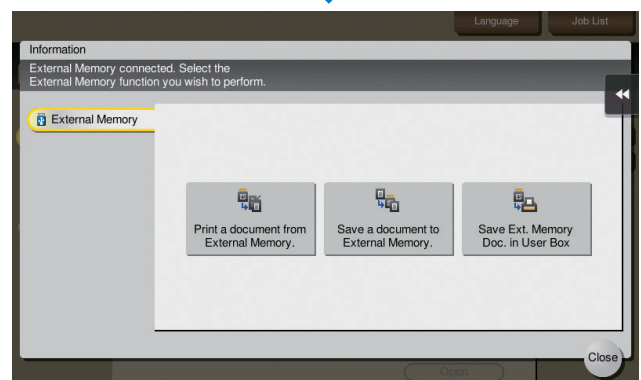

ID copy

This feature makes it easy to print the front and back of an ID card on the top and bottom of a single page. For extra easy access, place an ID Copy shortcut button on the top screen.

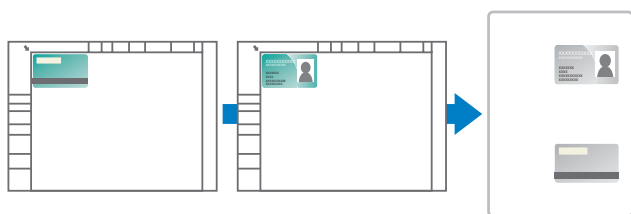

Automatic paper size measurement

Automatic paper size measurement can automatically measure the size of non-standard sized paper placed on the glass platen. It can also register the size in memory if desired. These features make it easy for anyone to handle non-standard paper sizes without making measuring mistakes or input errors.

Trays 1 and 2 of the standard cassette can feed non-standard size paper, which makes loading paper very easy when you need to bulk-print on non-standard size paper.

	Size	Basis weight
Tray 1	width: 139.7-297mm length: 182mm-431.8mm	52-256g/m ²
Tray 2	width: 139.7-320mm length: 182mm-457.2mm	



Minimal environmental impact

Low power consumption

bizhub 368e/308e minimises energy use during normal operation. It easily clears the latest Energy Star Program TEC standards and reduces both CO₂ emissions and TCO.

TEC values (kWh)

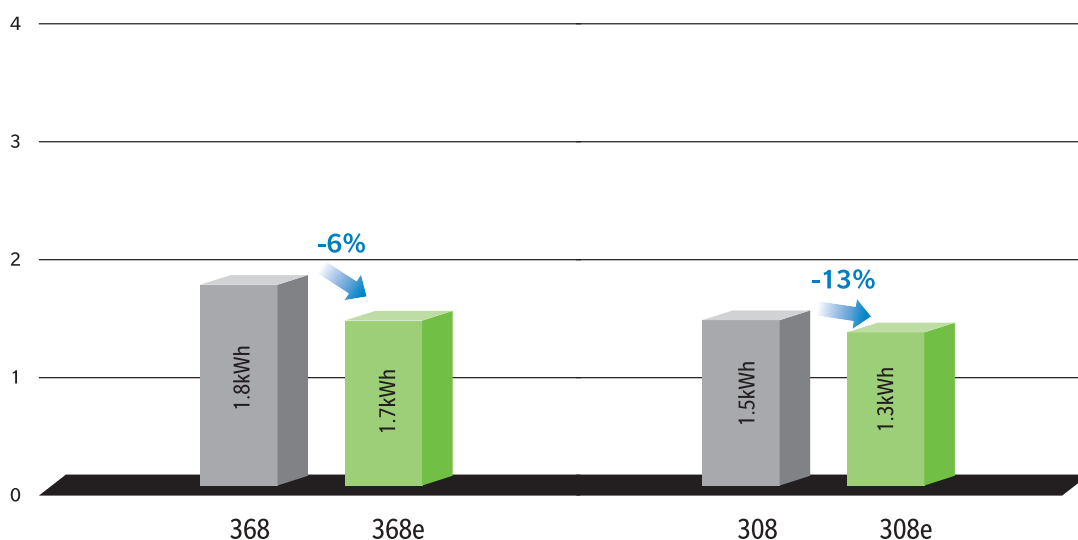

*Values for 220-240 V

*TEC values applied to the International Energy Star Program Version 2.0

Sleep mode

bizhub 368e/308e automatically switches to sleep mode after a user-defined period of inactivity. This mode reduces power consumption to a mere 0.5W by cutting off power to the CPU. When users want to use bizhub 368e/308e again, it switches back to full power in seconds.

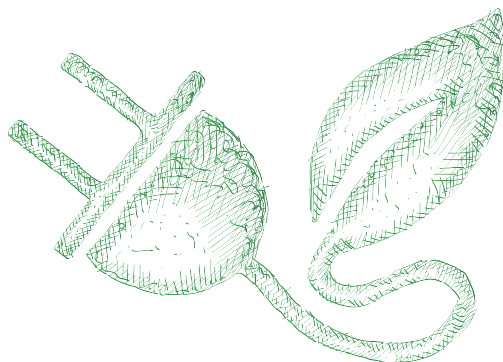

Eco-friendly materials

Approximately 78% of the outer surfaces and 36% of the weight of resin parts on bizhub 368e/308e consist of recycled materials. This includes PC/PET developed by Konica Minolta using advanced chemical processing technology. 70% of PC/PET on surfaces within the unit is PCR (post-consumer recycled).



● Recycled PC/ABS



MFP

bizhub 368e/308e

MONOCHROME MID-VOLUME MULTIFUNCTION PRINTER

bizhub 368e/308e

A3 multifunctional with 36/30 ppm b/w. Standard Emperon™ print controller with PCL 6, PCL 5, PostScript 3, PDF 1.7, XPS, and OOXML support. Paper capacity of 500 + 500 sheets and 150-sheet manual bypass. Media from A6 to SRA3, 1.2 m banner and 52 – 300 gsm. 4 GB memory, 250 GB hard disk and Gigabit Ethernet standard.

System Overview

System memory	4GB (standard)
System hard disk	250 GB (standard)
Interface	10-BASE-T/100-BASE-TX/1,000-BASE-T Ethernet, USB 1.1, USB 2.0, Wi-Fi 802.11a/b/g/n/ac (optional)
Network protocols	TCP/IP (IPv4/IPv6), SMB, LPD, IPP, SNMP, HTTP
Frame types	Ethernet 802.2, Ethernet 802.3, Ethernet II, Ethernet SNAP
Automatic document feeder (optional)	Up to 100 originals, A6-A3, DF-629: 35-128 gsm, DF-704: 35-163 gsm
Printable paper size	A6-SRA3, customised paper sizes, banner paper max. 1,200 x 297 mm
Printable paper weight	52-300 gsm
Paper input capacity	Standard: 1,150 sheets, Max.: 6,650 sheets
Tray 1	500 sheets, A5-A3, custom sizes, 52-256 gsm
Tray 2	500 sheets, A5-SRA3, custom sizes, 52-256 gsm
Tray 3 PC-115 (optional)	500 sheets, A5-A3, 52-256 gsm
Tray 4 PC-215 (optional)	2 x 500 sheets, A5-A3, 52-256 gsm
Paper feed cabinet PC-415 (optional)	2,500 sheets, A4, 52-256 gsm
Large capacity unit LU-302 (optional)	3,000 sheets, A4/Letter, 52-256 gsm
Bypass tray	150 sheets, Postcards, A6-SRA3, custom sizes, banner, 60-300 gsm
Automatic duplexing	Postcards, A6-SRA3, custom sizes, 52-256 gsm
Finishing modes (optional)	Group, sort, staple, punch, output tray, booklet, centre fold, tri-fold in
Power consumption	[220-240 V, 50/60 Hz] less than 1.58 kW (system)
System dimensions ^{*1}	[W x D x H] 615 x 685 x 779 mm
System weight ^{*2}	Approx. 76 kg

^{*1} Excluding ADF and lower paper tray unit^{*2} Including Drum/Developer

Copier Specifications

Copying process	Electrostatic laser copy, intermediate
Toner system	Simitri® HD Polymerized Toner
Copy/print speed A4	368e: Up to 36 ppm, 308e: Up to 30 ppm
1st copy out time	368e: 4.5 sec. or less, 308e: 4.8 sec. or less
Warm-up time	368e: 20 sec. or less, 308e: 18 sec. or less ^{*3} , 20 sec. or less ^{*4}
Copy resolution	600 x 600 dpi
Gradation	256 gradations
Multicopy	1-9,999
Original format	A6S, B6S, A5-SRA3
Magnification	25-400% in 0.1% steps, auto-zooming

^{*3} Time period from when the sub power off mode is released to when this machine is ready for printing while the Main Switch is ON state.^{*4} Time period from when the Main Power Switch is turned on to when this machine becomes ready for printing.

Printer Specifications

Print resolution	1,800 (equivalent) x 600 dpi, 1,200 x 1,200 dpi
Page Description Language	PostScript 3 (3016) Emulation, PCL 6 (XL Version 3.0) Emulation, PCL 5e/c Emulation, XPS
Operating systems W	Windows 7 (32/64), Windows 8.1 (32/64), Windows 10 (32/64), Windows Server 2008 (32/64), Windows Server 2008 R2, Windows Server 2012, Windows Server 2012 R2, Windows Server 2016, Macintosh OS X 10.7 or later, Linux, Unix, Citrix
Printer fonts	80 PCL, 137 PostScript 3 Emulation
Mobile printing	AirPrint (iOS), Mopria (Android), Google Cloud Print (optional), Wi-Fi Direct (optional), Konica Minolta Print Service (Android), Konica Minolta Mobile Print (iOS, Android, Windows 10 Mobile)

Scanner Specifications

Scan speed with DF-629	1-sided original: 55 ipm (600 dpi), 80 ipm (300 dpi) 2-sided original: 26 ipm (600 dpi), 37 ipm (300 dpi)
Scan speed ^{*5} with DF-704 (optional)	1-sided original: 55 ipm (600 dpi), 80 ipm (300 dpi) 2-sided original: 110 ipm (600 dpi), 160 ipm (300 dpi)
Resolution	Max.: 600 x 600 dpi
Scan modes	Scan to Email, Scan to PC (SMB), Scan to FTP, Scan to WebDAV, Scan to BOX (HDD), Scan to WSD (Web Service), Scan to DPWS (Device Profile for Web Service), Scan to Scan Server, Scan to USB memory, Network TWAIN scan, Scan to Me, Scan to Home
File formats	JPEG, TIFF, PDF, PDF/A-1a ^{*6} , PDF/A-1-b ^{*6} , compact PDF, encrypted PDF and searchable PDF ^{*6} , XPS, compact XPS, OOXML (pptx, docx ^{*6} , xlsx ^{*6}), Linearized PDF ^{*6}
Destinations	2,100 (single + group), LDAP, PSDA support

^{*5} When copying A4^{*6} Optional

Fax Specifications (optional)

Fax	Super G3
Transmission	Analog fax, Internet fax, Colour Internet fax, IP address fax
Resolution	Max.: 600 x 600 dpi (ultra-fine)
Compression method	MH, MR, MMR, JBIG
Modem speed	Up to 33.6 Kbps
Destinations	2,100 (single + group)

Components and Options

DK-510 Copier desk!	Provides storage space for print media and other materials
DK-705 Caster table	Used to install this machine on the floor
FS-533 Inner finisher	50-sheet stapling, 500 sheets max. output
PK-519 Punch kit	For FS-533, 2/3/4 hole punching, Auto switching
FS-536 Staple finisher	50-sheet stapling, tray1: max. 200-sheet output, tray2: max. 3,000-sheet output
FS-536SD Staple/booklet finisher	50-sheet staple finisher, 20-sheet booklet finisher, tray1: max. 200-sheet output, tray2: max. 2,000-sheet output
RU-513 Relay unit	For FS-536/SD installation
DK-520 Punch kit	For FS-536/SD, 2/3/4 hole punching, Auto switching
JS-506 Job separator	Separation for fax output, etc.
CU-101 Air cleaning unit	Improving indoor air quality by reduced emissions
MK-745 Mount kit	Installation kit for CU-101
MK-730 Banner paper mount kit	Banner paper feeder
HT-509 Dehumidification heater	Dehumidification heater for Paper feed cabinet, for PC-115/215/415, DK-510
MK-734 Dehumidification heater power supply box	Dehumidification heater power supply box (Cabinet heater), for PC-115/215/415, DK-510
TK-101 Transformer kit	Required to enable the function heater of the Large capacity unit LU-302
KP-101 10-Key pad	10-key
DF-704 Document feeder	Dual scan automatic document feeder, capacity 100 originals
SP-501 Stamp unit	Stamps a scanned original when sending a fax
WT-506 Working table	Authentication device placement
FK-514 Fax board	Super G3 fax, fax functionality for 1st and 2nd line
LK-102 v3 PDF enhancements	PDF/A, PDF encryption, digital signature
LK-104 v3 Voice guidance	Provides voice guidance functions
LK-105 v4 OCR text recognition	Searchable PDF and PPTX, PDF/A-1a
LK-106 Barcode fonts	Supports native barcode printing
LK-107 Unicode fonts	Supports native Unicode printing
LK-108 OCR A and B fonts	Supports native OCR A and B font printing
LK-110 v2 Document converter pack	Generates various file formats incl. DOCX, XLSX and PDF/A
LK-111 ThinPrint® Client	Print data compression for reduced network impact
LK-115 v2 TPM activation	Trusted Platform Module for protection of data encryption and decryption
KH-102 Keyboard holder	To place USB keyboard
EK-608 USB I/F kit	USB interface kit
EK-609 USB I/F kit	USB interface kit, Bluetooth LE
SC-508 Security kit	Copy guard function
MK-735 Mount kit	Installation kit for IC card reader
AU-2015 IC card authentication	Various IC card technologies
UK-212 Wireless LAN	Wireless LAN and wireless LAN Access Point Mode
HD-524 Hard disk mirroring kit	Back-up HDD

- All specifications refer to A4-size paper of 80 gsm quality.
- The support and availability of the listed specifications and functionalities vary depending on operating systems, applications and network protocols as well as network and system configurations.
- Some of the product illustrations contain optional accessories.
- Specifications and accessories are based on the information available at the time of printing and are subject to change without notice.
- Konica Minolta does not warrant that any specifications mentioned will be error-free.
- All brand and product names may be registered trademarks or trademarks of their respective holders and are hereby acknowledged.



KONICA MINOLTA

Konica Minolta
Business Solutions Australia Pty Ltd

Free Call 1800 789 389
konicaminolta.com.au

New South Wales

Konica Minolta House
4 Drake Avenue
Macquarie Park NSW 2113
(02) 8026 2222

ACT

1/55 Wentworth Avenue
Kingston ACT 2604
(02) 6206 6500

Victoria

Level 5, 441 St Kilda Road
Melbourne VIC 3004
(03) 8699 0777

South Australia

L1 84 Greenhill Road
Wayville SA 5034
(08) 8231 2911

Queensland

Level 9, 100 Skyring Terrace
Newstead QLD 4006
(07) 3872 9100

Western Australia

140 Hay Street
Subiaco WA 6008
(08) 6380 3700

bizhub 308e/368e



1. Option in some regions 2. Optional



Ecology & Environment

KONICA MINOLTA copiers and multi-functional products are designed with the environment in mind.

- Energy Star
- Eco-conscious Toners
- RoHS Compliance
- Production at ISO Certified Factories
- WEEE Compliance



Requirements for safe use.

- Please read and follow the instruction manual to ensure safe operation.
- Only operate using appropriate power supply and voltage.
- Connecting the earth wire to an inappropriate place may cause explosion or electric shock. Please connect accordingly

Product appearance, configuration and/or specificants are subject to change without notice.

The Konica Minolta logo and the symbol mark, are registered trademarks or trademarks of Konica Minolta Holdings, Inc. bizhub, PageScope, Simitri and the Emperon logo are registered trademarks or trademarks of KONICA MINOLTA BUSINESS TECHNOLOGIES, INC. Windows is registered trademark of Microsoft Corporation in the United States and other countries. Adobe and PostScript are registered trademarks or trademarks of Adobe Systems Incorporated. All other brand and product names are registered trademarks or trademarks of their respective owners.

Printed on a Konica Minolta AccurioPrint C2060L